

JB **JETBLACK**[™]
ACCESSIBLE PERFORMANCE



UNBOXING &
INSTALLATION
GUIDE



TRAINER TABLE

*DESIGNED FOR THE PERFECT
PLACEMENT OF TABLETS,
SMARTPHONES AND LAPTOPS USED
WHILE CYCLE TRAINING.*

QUICK START GUIDE

LIST OF COMPONENTS

- | | |
|-----------------------------------|---|
| 1. Table top | 6. Plastic packer (x2) |
| 2. Base Junction | 7. Hexagon wrench - CRV3 |
| 3. Support tube | 8. Hexagon wrench - CRV4 |
| 4. Rear support leg | 9. Inner hexagonal head screw - M5 (14) |
| 5. Front support leg (Right/Left) | 10. Inner hexagonal head screw - M6 (2) |



CLEANING AND MAINTENANCE

Regularly wipe down with a damp cloth to remove any sweat or moisture.

WARNING:

This device must be used only for the purpose it was expressly designed; any use not complying with the instructions contained in the manual is considered inappropriate and dangerous. The manufacturer is not responsible for possible damages caused by the inappropriate and/or unreasonable use.

Packing materials (plastic bags, expanded polystyrene, etc) must be kept out of the reach of children or disabled persons.

The installation/assembly of the device must be made according to the manufacturers instructions. Failure to do so may cause damage to persons, animals or objects, for which the manufacturer will not be considered responsible.

Place and use the device on a horizontal and stable surface. Do not hang heavy objects on the table. **Weight Limit - 10kg**

SETTING UP YOUR TABLE

1. Install the support legs, rear and front

Use the M5 screws (x10)



2. Install the support tube

Important: Ensure to loosen the support tube clamp and slide out the support tube approximately 10cm before attaching the base junction.

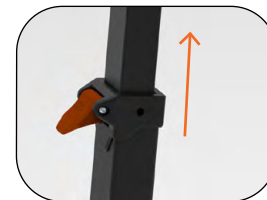

Then install the base junction, using the M5 screws (4). Ensure the logo is facing the same direction as the long, forward angled feet.



ENJOY YOUR RIDE EVEN MORE WITH ALL YOUR DEVICES EXACTLY WHERE YOU NEED THEM DURING YOUR INDOOR CYCLE TRAINING SESSION.

3. Attach the table top

- 1 Press the spring pin with your finger.

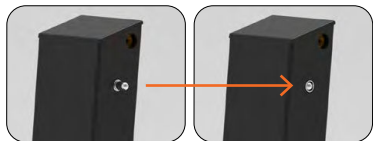

- 2 Attach the table top.
NOTE: Ensure the spring pin enters the limit hole.

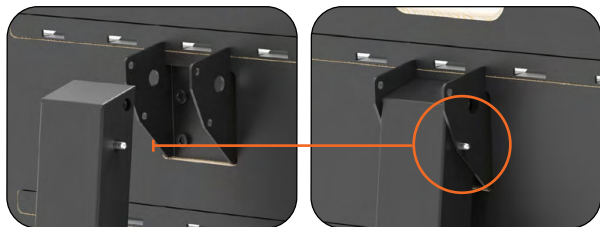

- 3 Insert the plastic packers and M6 screws (2). Tighten with the hexagonal wrench (8).
NOTE: When the screw is locked, press the spring pin, turn the table top to check it is smooth.



4. Instructions for use

- 1 Press the spring pin with your finger to release the table top. Lift the table top to the horizontal position, until it locks in place.

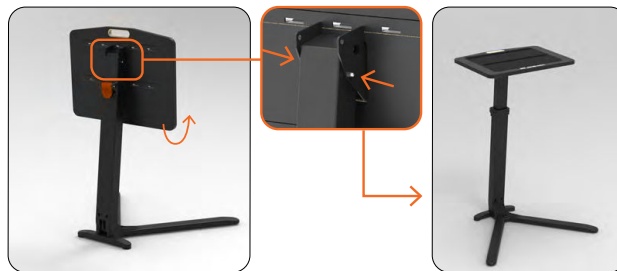

- 2 Loosen the support tube adjustment clamp to raise or lower the table height. Tighten the clamp to secure.

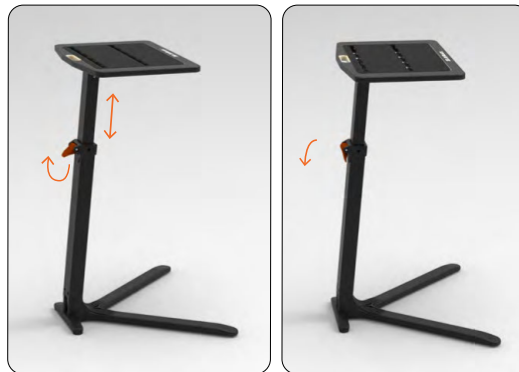

Use the built-in tablet and smartphone cutouts to ensure sturdy positioning of your devices. Note: Some devices with protective covering may not correctly fit the cutout slots. You may need to remove the protective covering to ensure a secure fit.



JETBLACK

INTRODUCING THE
**TRAINER
SUITE**

EXPLORE THE FULL RANGE AT
WWW.JETBLACKCYCLING.COM

#LOVETORIDE

